

Description

D45 System interface device used to mix signals coming from 5 entrance panels.
 The video transfer distance can be adjusted by setting the gain adjustment DIP SWITCH.
 DIN RAIL installation.
 Possibility to connect in cascade several entrance panel video mixer.

Technical data

Power supply: 30 Vdc
 Stand by current absorption: ≤ 20 mA @ 30 V
 Max operating current absorption: ≤ 60 mA @ 30 V
 Stand by power consumption: 0.6 W
 Operating power consumption: 1.8 W
 Operating temperature: (-10)-(+40)°C

Dimensional data

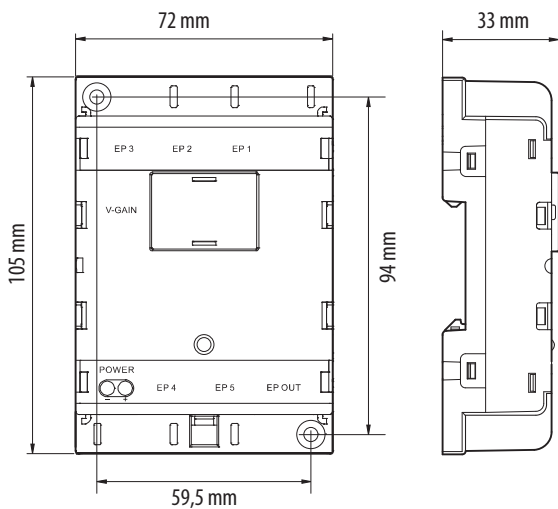

Upper view

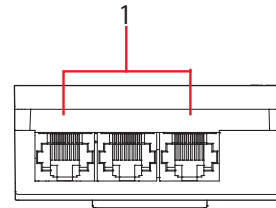

Front view

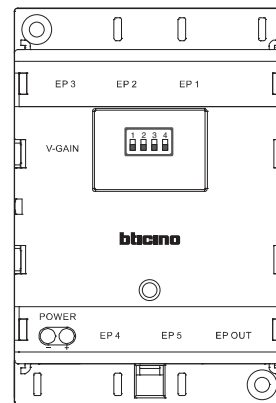

Lower view

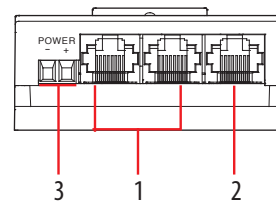

Legend

- 1. RJ45 System BUS entrance panels (EP1 to EP5) connections
- 2. RJ45 Entrance panels output connector. Connect to D45 system BUS
- 3. 30 Vdc power supply input connector

Video gain settings

DIP switch setting instruction



	Distance	1	2	3	4
Colour signal	0 – 300 m	OFF	OFF	OFF	OFF
	300 – 700 m	ON	OFF	OFF	OFF
	700 – 1000 m	ON	ON	OFF	OFF
B/W signal	1000 – 1500 m	ON	ON	ON	OFF
	1500 – 2000 m	ON	ON	ON	ON