

61803850	<b>DATA SHEET</b>	
Valid from: 13.03.2019	<b>SILVYN® COMPACT 45° M</b>	

The SILVYN® COMPACT 45° M is a conduit gland that provides optimum assembly conditions due to the compact dimensions.

In combination with liquid-tight conduits (galvanized steel tube with coating), it forms an easy to install system with high protection degree.



**Material:**

Body	Brass, nickel plated
Sleeve	Steel, galvanized
O-Ring	NBR
Clamping ring	Polyamide 6

**Technical Features:**

Connecting thread	M16x1,5 up to M32x1,5 acc. to DIN 60423
Nominal width	NW 5/16" up to NW 1"
Protection class	IP67 acc. to EN 60529
Temperature range	Depending on the used conduit -45°C up to +105°C



**Approvals:**

**Reference standards:**

IEC 61386-1

**Suitable conduits:**

SILVYN® HTDL  
SILVYN® EF  
SILVYN® OR  
SILVYN® HCX  
SILVYN® HFX

For more information please see our current catalogue. Please do not hesitate to contact our laboratory if there are any questions regarding resistance against aggressive agents and special oil.

Creator: MAAU1 /PDP Released: DAMU1/PDP	Document: DB61803850EN Version: 03	Page 1 of 2
--	---------------------------------------	-------------

61803850	<b>DATA SHEET</b>	
Valid from: 13.03.2019	<b>SILVYN® COMPACT 45° M</b>	

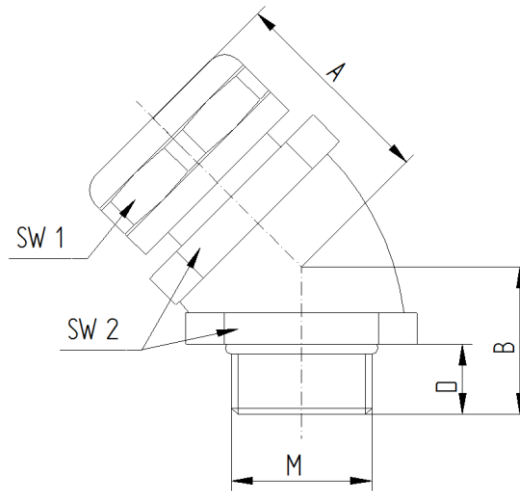

**Dimension table:**

Part No.	NW	Thread	Thread Length mm	Length D mm	Length B mm	Inner Diameter mm	SW 1	SW 2	Weight Kg/100
6180 3848	5/16"	M16x1,5	10	27	19	8,3	26	22	6,3
6180 3850	3/8"	M16x1,5	10	27	19	11,0	26	22	6,3
6180 3849	5/16"	M20x1,5	10	28	20	8,3	26	24	7,2
6180 3851	3/8"	M20x1,5	10	28	20	11,0	26	24	7,2
6180 3852	1/2"	M20x1,5	10	30	21	14,5	29	27	8,3
6180 3853	3/4"	M25x1,5	10	33	23	19,4	35	33	12,8
6180 3854	1"	M32x1,5	12	38	28	24,7	45	42	22,5

Creator: MAU1 /PDP Released: DAMU1/PDP	Document: DB61803850EN Version: 03	Page 2 of 2
---	---------------------------------------	-------------