

INSTRUCTION

LINEDO

982773.000.6



~ 220 - 240 V 50 Hz IP 20 IK02



Umgebungstemperatur /
temperature ambiante
=> -25 °C ... + 50 °C

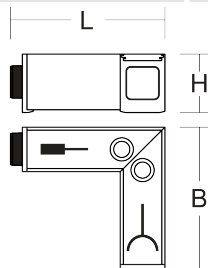
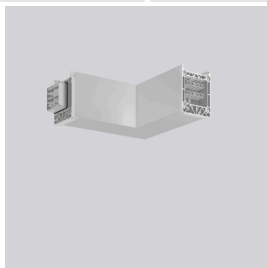

L 204, B 185, H 76



640 g

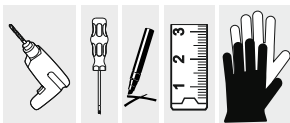



Installation erfordert
Elektro-Fachkraft!

Symbole nach ISO 7010



Allgemeine Sicherheitshinweise

- Der elektrische Anschluss muss ordnungsgemäß nach geltenden Normen und den nationalen sowie internationalen Sicherheits- und Unfallverhütungsvorschriften erfolgen.
- Beschädigte Leuchten dürfen nicht betrieben werden.
- Keine Haftung für Schäden durch unsachgemäßen Einsatz.
- Bei Instandsetzung nur Originalteile verwenden.
- Tragfähigkeit der Decke und Befestigungselemente sicherstellen.

Betrieb der Leuchte

- Die unzulässigen Umgebungstemperaturen reduzieren die Lebensdauer der Leuchte, im Extremfall droht der Frühausfall.
- Zur Vermeidung von EMV-Problemen die Durchgangsverdrahtung nicht entlang der Leuchtenverdrahtung führen.
- Steuereingänge von dimmbaren Leuchten mit handelsüblichen für Netzspannung geeigneten Leitungen anschließen.

Manipulationen unserer Produkte sind unzulässig

Veränderung, Umarbeitung, Umkennzeichnung von Produkten sowie deren Verpackung sind unzulässig und verletzen u.a. unsere eingetragenen Warenzeichenrechte. Solche Modifikationen können technische Eigenschaften unserer Produkte negativ beeinflussen, diese zerstören und möglicherweise Folgeschäden an anderen Objekten verursachen. Für durch derartige Modifikationen verursachte Schäden kann der Hersteller in keinem Fall verantwortlich gemacht werden.



Installation requires
a qualified electrician!

Symbols according
to ISO 7010



General Safety Information

- Electric connection must be appropriate according to all applicable standards and other national and international safety and accident prevention regulations.
- Damaged luminaires must not be operated.
- No liability is accepted for damages resulting from improper use.
- Use genuine parts only for repair.
- Ensure stability of the ceiling and fastening elements.

Operation of the luminaire

- Exceeding the permissible ambient temperature will reduce the luminaire's lifecycle, resulting in premature failure in extreme cases.
- Avoid ESD problems by not routing feed-through wiring directly along the wiring of the luminaire.
- Connect control inputs of dimmable luminaires with standard cables suitable for power supply voltage.

Manipulation of our products is not permitted

Modifications, reworking, re-labelling of products as well as their package is not permitted and infringes, amongst others, our registered trademark rights. Such modifications may affect technical properties of our products, damage them and possibly cause consequential damage to other objects. The manufacturer shall not be responsible under any circumstances for damage caused by such modifications.



DIN EN IEC 61340-5-1

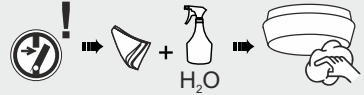

Bei Fragen zu unseren Symbolen, besuchen Sie folgende Webseite:

If you have any questions about our signs, visit the following website:



https://www.rzb.de/fileadmin/assets/downloads/PDF/RZB_Symbolklaerung.pdf

Hinweis zum Einsatz von Leuchten mit D - Kennzeichnung nach EN 60598-2-24

Reference for application of lumiaires with D - marking according to EN 60598-2-24

IP 4x



Umgebung ohne Staubablagerung

Environment without dust deposit

IP 5x



Umgebung mit nicht elektrisch leitender Staubablagerung

Environment with non-electrically conductive dust deposit

IP 6x



Umgebung mit elektrisch leitender Staubablagerung

Environment with electrically conductive dust deposit



	Stecker / Plug		Pendelmontage / Pendant mounting Einspeisung Mitte / Feed in the middle
	Buchse / Socket		Deckenmontage / Ceiling mounting Einspeisung Mitte / Feed in the middle
	Pendelmontage / Pendant mounting		Deckenmontage / Ceiling mounting Einspeisung Anfang von oben / Feed beginning from above
	Deckenmontage / Ceiling mounting		Pendelmontage / Pendant mounting Einspeisung Anfang von oben / Feed beginning from above
	Verdrahtung anpassen / Adapt wiring		Deckenmontage / Ceiling mounting Einspeisung Anfang seitlich / Feed beginning from the side
	Werkseinstellungen / Factory setting		Pendelmontage / Pendant mounting Einspeisung Anfang seitlich / Feed beginning from the side
			L-Verbinder / L-Connector
			L-Verbinder / L-Connector
			X,T-Verbinder / X,T-Connector
			X,T-Verbinder / X,T-Connector

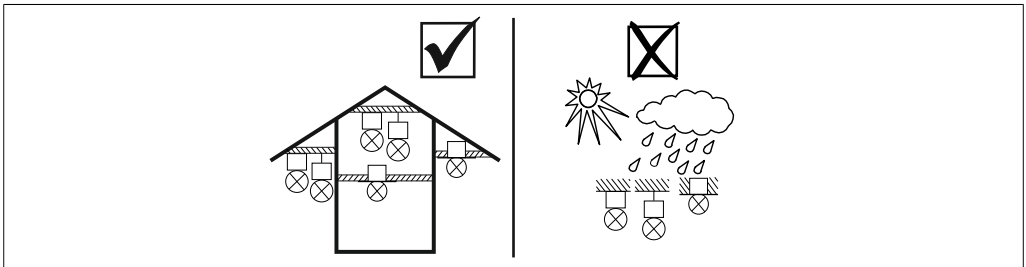
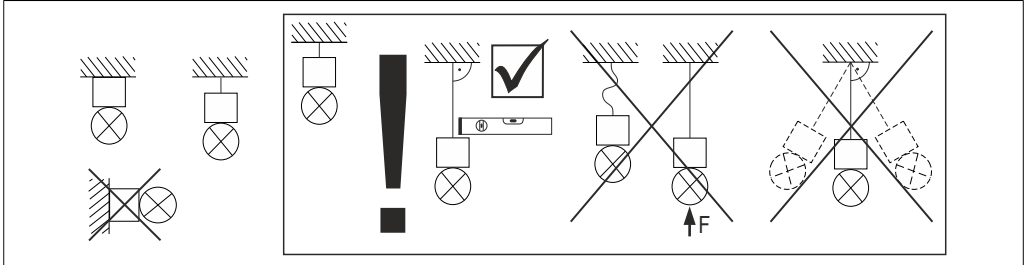



Verdrahtung / wiring		I max.	7x	14x
L1	Phase 1 / <i>phase 1</i>	16 A		
L2	Phase 2 / <i>phase 2</i>	16 A		
L3	Phase 3 / <i>phase 3</i>	16 A		
	Schutzleiter / <i>Protective conductor</i>			
N	Neutralleiter / <i>Neutral conductor</i>			
D1	DALI DA / <i>DALI DA</i>			
D2	DALI DA / <i>DALI DA</i>			
1	Notbeleuchtung Kreis 1 / <i>emergency lighting circle 1 (L / L+)</i>	6 A		
2	Notbeleuchtung Kreis 1 / <i>emergency lighting circle 1 (N / N-)</i>	6 A		
3	Steuer oder geschaltetes Signal / <i>Control or switched signal L (SE)</i>	6 A		
4	Schutzleiter / <i>Protective conductor</i>			
5	Steuer oder geschaltetes Signal / <i>Control or switched signal N (SE)</i>	6 A		
6	Notbeleuchtung Kreis 2 / <i>emergency lighting circle 2 (L / L+)</i>	6 A		
7	Notbeleuchtung Kreis 2 / <i>emergency lighting circle 2 (N / N-)</i>	6 A		

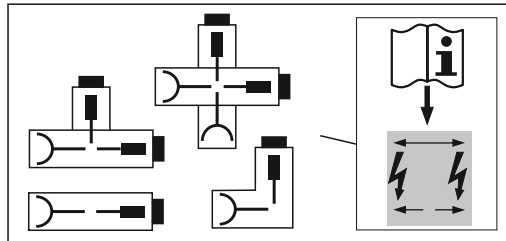
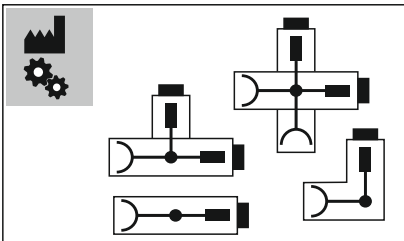
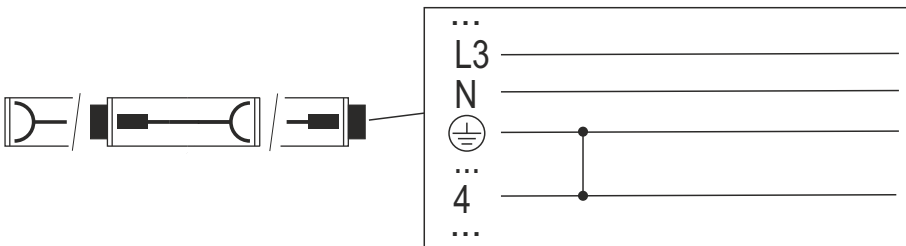

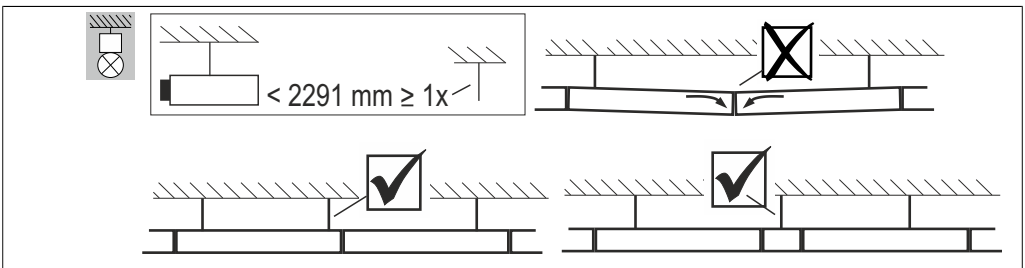
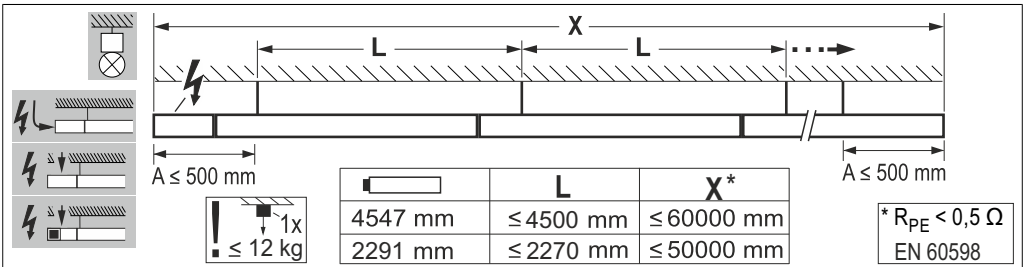
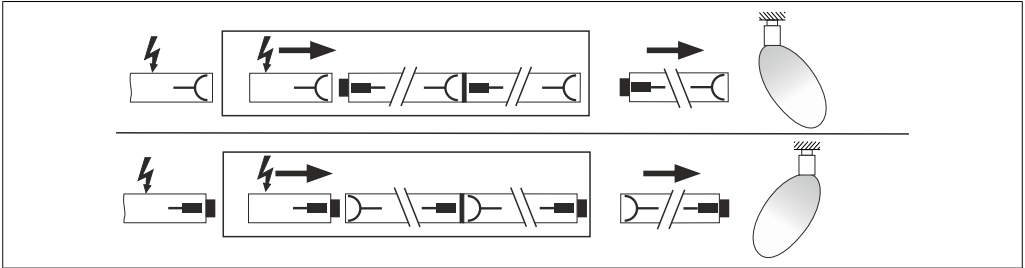
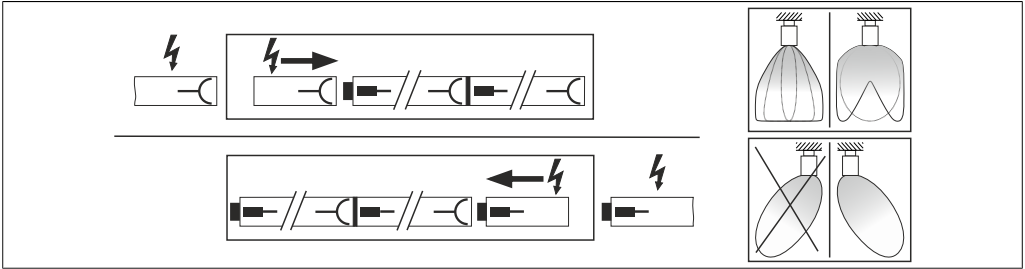
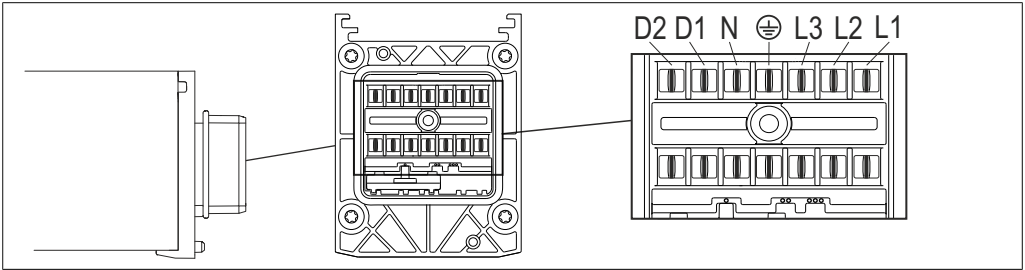

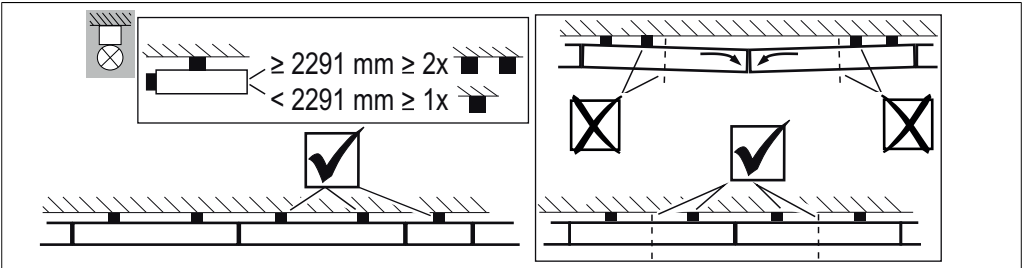
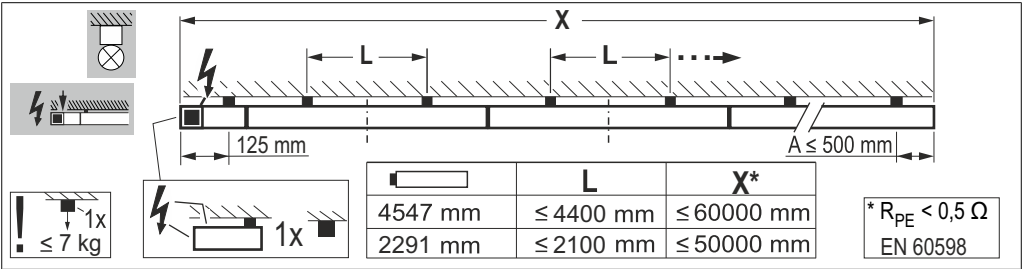

1

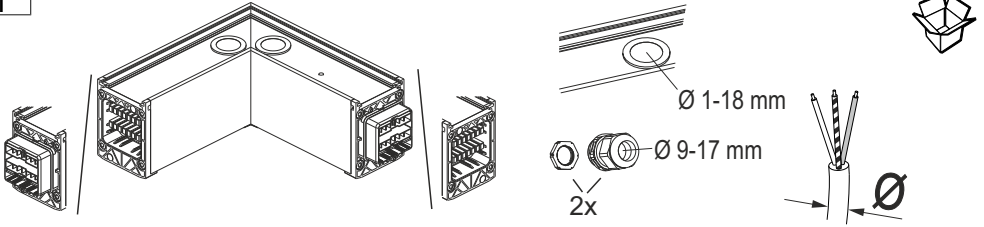

2

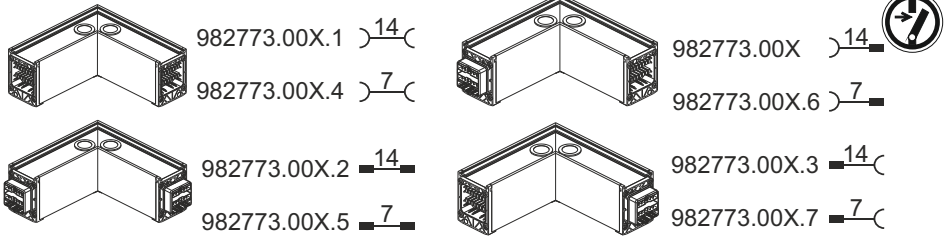

3

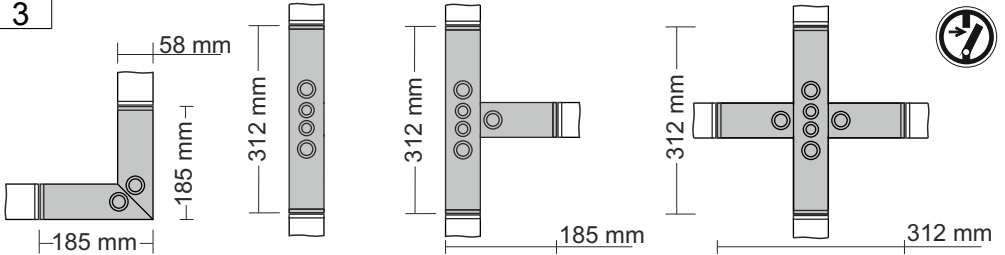

4

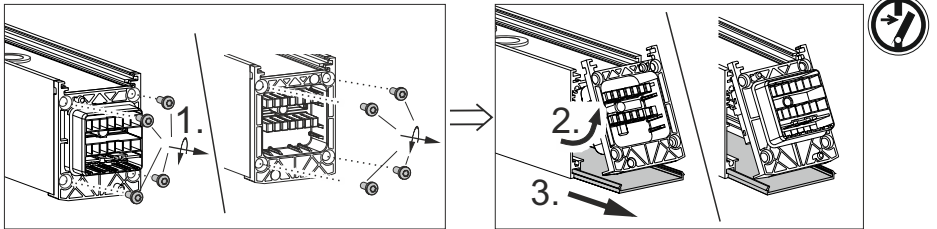

5

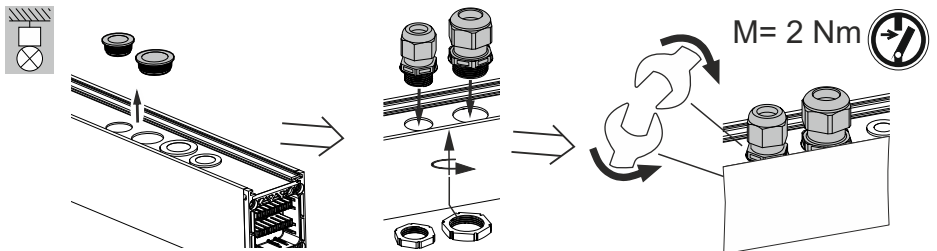

6

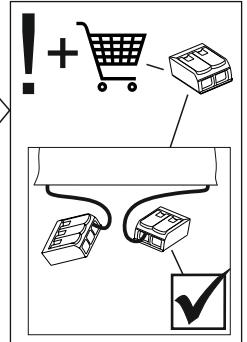
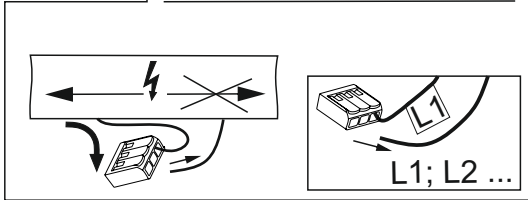
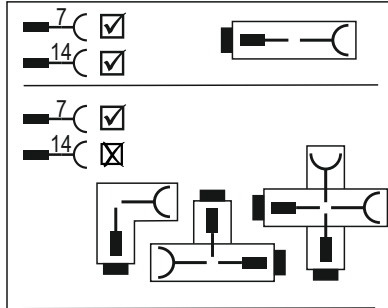
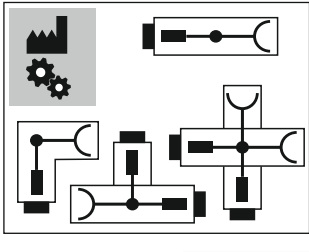

7

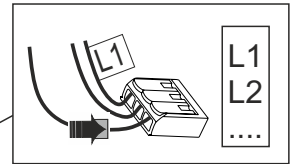
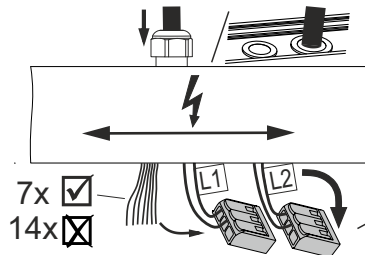
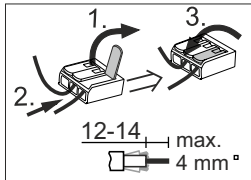

8a

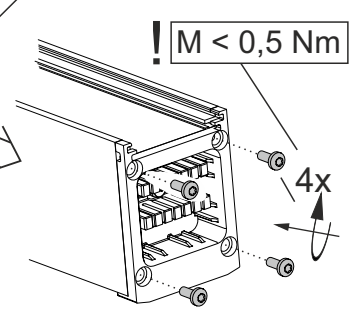
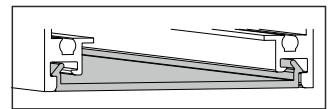
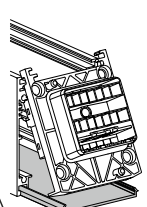
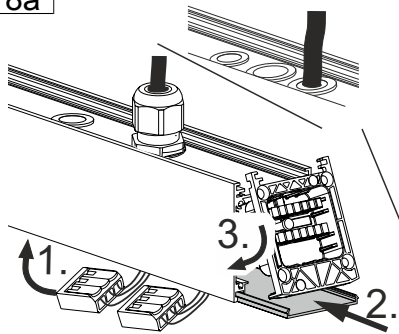

8b

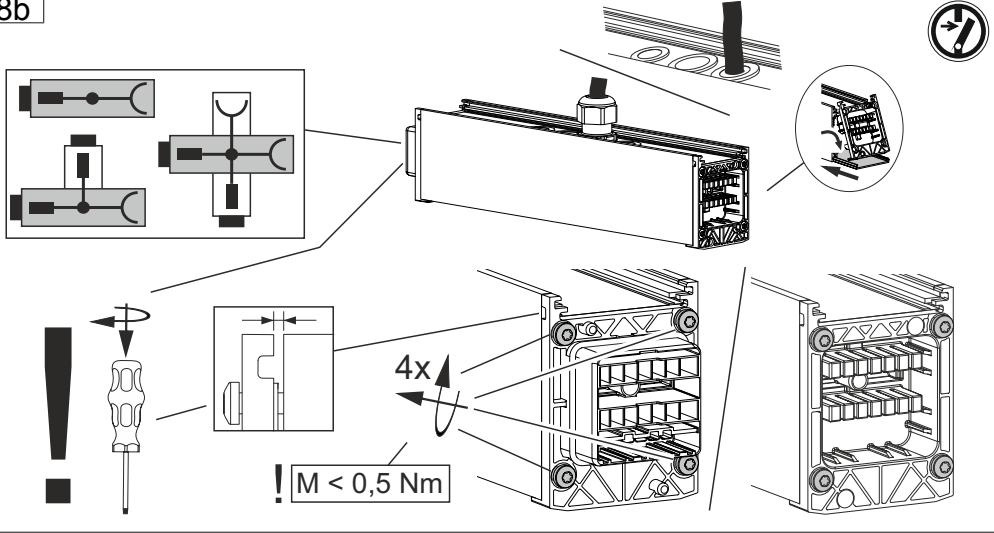

9a

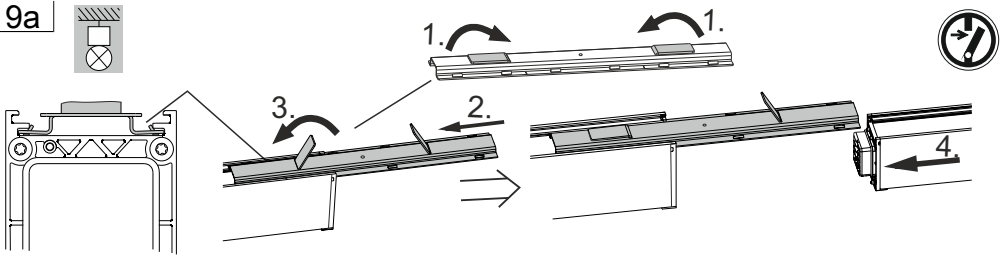

9b

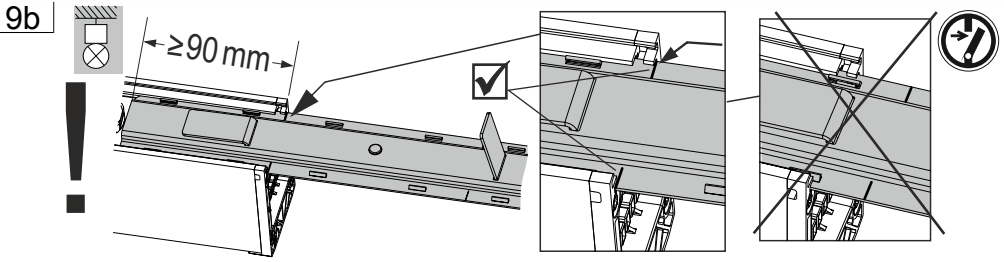

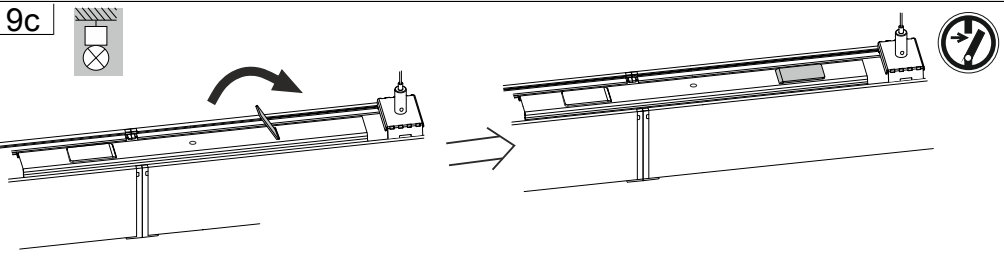

9c

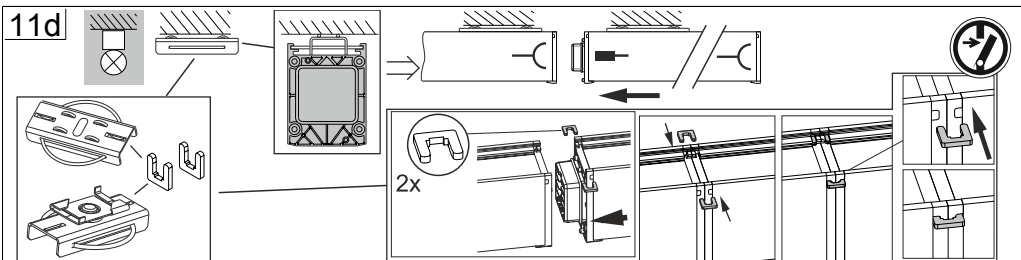
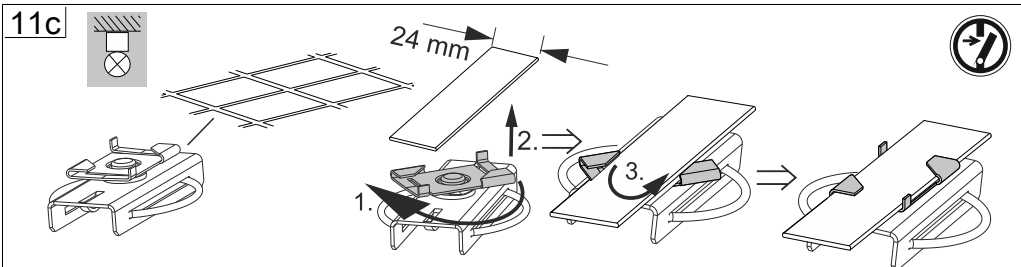
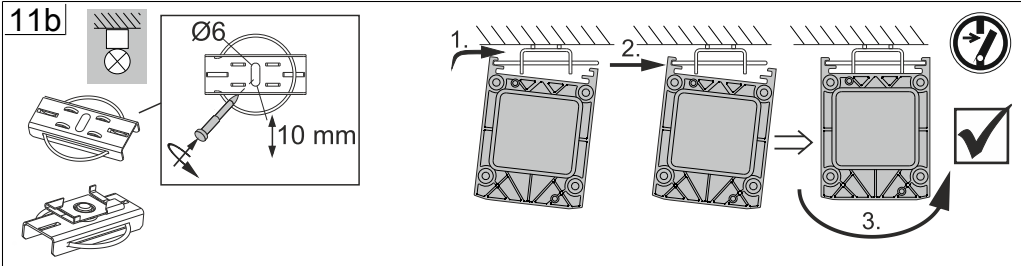
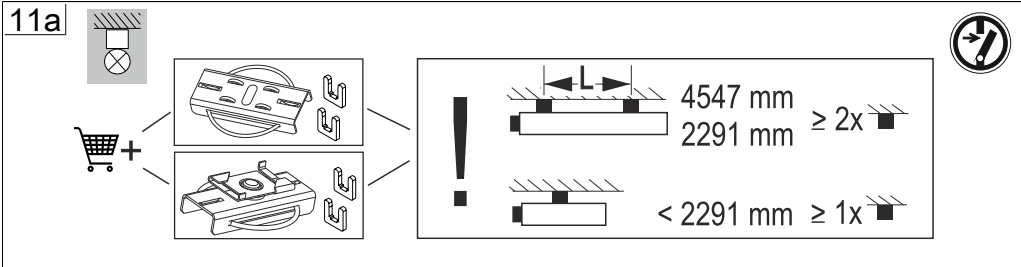
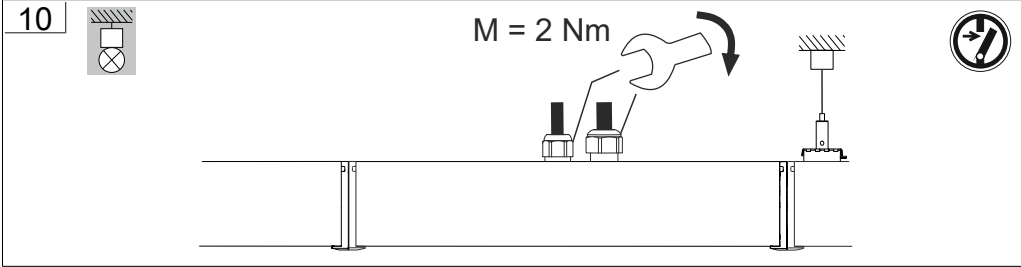





RZB - Rudolf Zimmermann, Bamberg GmbH

 Rheinstraße 16, 96052 Bamberg

 0951/7909-0

 0951/7909-198

 info@rzb-leuchten.de