

Product Data Sheet

GW76895

GW FIT Range



Systems of accessories for electrical installations used for residential, tertiary and industrial applications. The system consists of fasteners for pipes and cables, cable fittings, accessories for rigid pipes (RK Series) and flexible conduit (DF Series). The system include also a wide variety of cable ties (52FS Range) and terminal blocks (44 Range).

IP degree	IP68 (at 3 bar)	Material	Nickel-plated brass
For cables Ø (mm)	from 34 to 48	Description	Cable gland
Type of pitch	M63	Operating temperature	-30 +100 °C
Electrocod	3651		

DIMENSIONAL

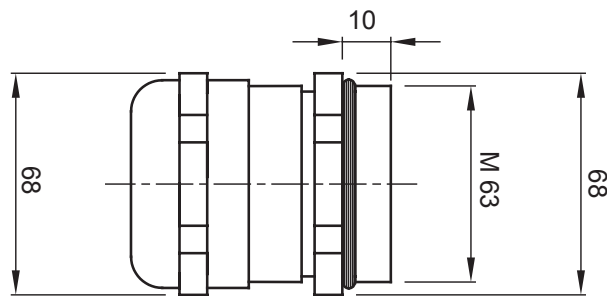

TECHNICAL SYMBOLOGY

IP

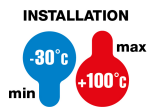

IP68 (at 3 bar)

STANDARDS/APPROVALS

