

Product Data Sheet

GW92791

90 MCB Range



Description MINIATURE CIRCUIT BREAKER

Code MT 100

No. of poles 4P

No. modules 4

Rated current 40 A

Curve D

Rated voltage 230-400 V

| | | | |
|---|---|---|---|
| Standard | EN 60898, EN 60947-2 | Rated frequency (Hz) | 50/60 Hz |
| Breaking capacity EN 60898 230V (Icn) | 10000 A | Breaking capacity EN 60898 400V (Icn) | 10000 A |
| Breaking capacity EN 60898 (Ics) | 0.75 x Icn | Breaking capacity IEC/EN 60947-2 230V (Icu) | 20 kA |
| Breaking capacity IEC/EN 60947-2 400V (Icu) | 12.5 kA | Breaking capacity IEC/EN 60947-2 (Ics) | 50% Icu |
| Insulation voltage | 500 V | Rated impulse withstand voltage | 4 kV |
| Minimum operating voltage | 12V ac/dc | Maximum operating voltage | 440V AC / 220V DC |
| Electrical endurance | 10.000 | Mechanical endurance | 20.000 |
| Section rigid cable | <=1x35 - <=2x16 - <=1x16+2x10 mm ² | Section flexible cable | <=1x35 - <=2x16 - <=1x16+2x10 mm ² |
| Rated tightening torque | 2 Nm | Operating temperature | -25 +60 °C |
| Stocking temperature | -40 +70 °C | Electrocod | 1411 |

DIMENSIONAL

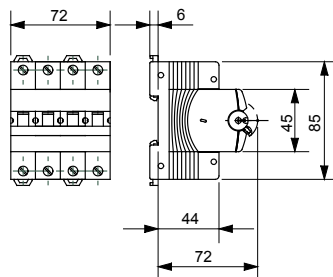

STANDARDS/APPROVALS



GEWISS S.p.A. Via A. Volta, 1
24069 Cenate Sotto - Bergamo - Italy
tel. +39 035 94 61 11 fax +39 035 94 69 09

www.gewiss.com
sat@gewiss.com
Last update 20/04/2023

Data, measures, designs and pictures are shown
only as informative purposes,
and could be changed without previous notice