

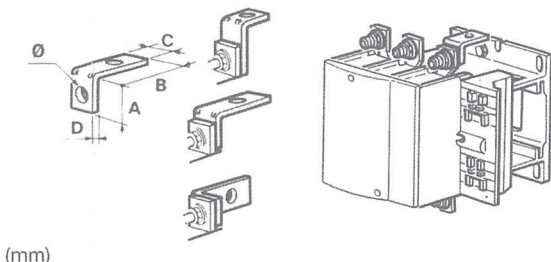



3 x 	A	B	C	D	∅
LA9-FF981 (LC1-F115)	15	42	15	3	6,5
LA9-FG981 (LC1-F150/185)	20	45	20	3	9
LA9-FJ981 (LC1-F225...400)	25	55	25	4	11
LA9-FK981 (LC1-F500)	30	52	30	5	11
LA9-FL981 (LC1-F630)	40	86	40	8	13



3 x 	A	B	C	D	∅
LA9-FF979 (LC1-F115)	54	80	15	5	6,5
LA9-FG979 (LC1-F150/185)	58	92	20	5	9
LA9-FJ979 (LC1-F225...400)	64	120	25	6	11
LA9-FK979 (LC1-F500)	68	120	30	6	11
LA9-FL979 (LC1-F630)	117	130	40	10	13

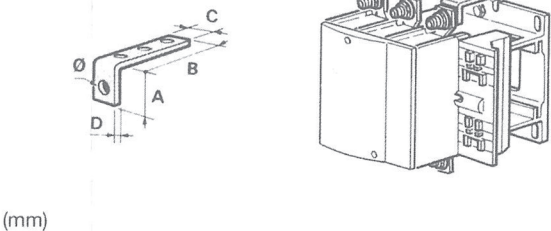

3 x 	A	B	C	D	E	F	G	∅
LA9-FF980 (LC1-F115)	25	40	15	3	35	26	71	6,5
LA9-FG980 (LC1-F150/185)	32	45	20	3	40	23	89	9
LA9-FJ980 (LC1-F225...400)	35	55	25	5	50	28	99	11
LA9-FK980 (LC1-F500)	41	65	30	5	60	28	114	11
LA9-FL980 (LC1-F630)	53	85	40	10	100	33	154	13

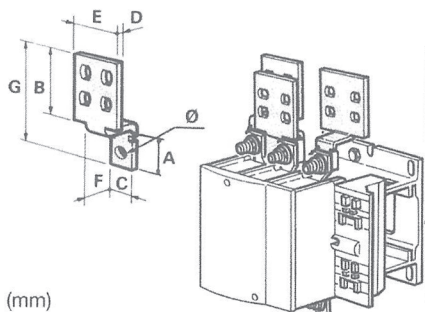

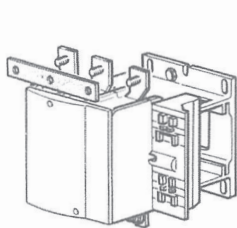

LA9-F.601

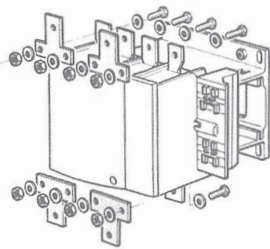
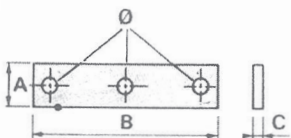

LA9-F.602

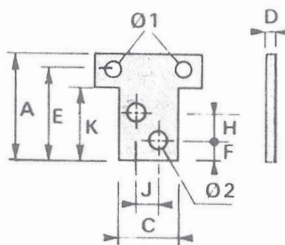
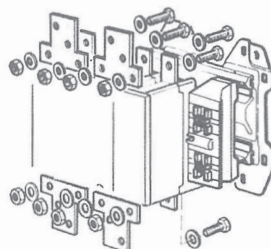
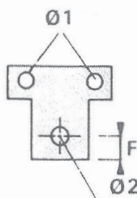

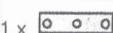
1 x 	A	B	C	Ø
LA9-FF601 (LC1-F115)	15	89	3	6,5x8,5
LA9-FG601 (LC1-F150/185)	20	100	3	8,5x10,5
LA9-FH601 (LC1-F225...400)	20	121	5	10,5x13
LA9-FK601 (LC1-F500)	30	140	5	11
LA9-FL601 (LC1-F630)	40	200	8	13

(mm)

4 x 	A	C	D	E	F	H	J	K	Ø1	Ø2
LA9-FF602 (LC1-F115)	45	25	4	37,5	12,5	-	-	30	6,5	11
LA9-FG602 (LC1-F150/185)	55	30	5	45	15	-	-	35	9	11
LA9-FH602 (LC1-F225...400)	60	40	8	52,5	15	-	-	40	11	13
LA9-FK602 (LC1-F500)	85	50	10	70	14	22	22	55	11	11
LA9-FL602 (LC1-F630)	100	60	10	85	17	26	26	65	13	14

(mm)



C : Nm

FF (F115)	FG (F185) (F150)	F225	FH (F265)	F330	FJ (F400)	FK (F500)	FL (F630)
10	18	35	35	35	35	35	58