

PRODUCT-DETAILS

KLC T3 KEY LOCK RONIS OP, X C.BREAK.

KLC T3 KEY LOCK RONIS OP, X C.BREAK.

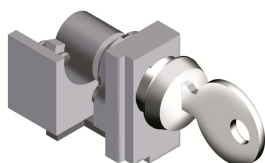

General Information

Extended Product Type	KLC T3 KEY LOCK RONIS OP, X C.BREAK.
Product ID	1SDA053530R1
EAN	8015644544782
Catalog Description	KLC T3 KEY LOCK RONIS OP, X C.BREAK.
Long Description	KEY LOCK RONIS 622 IN OPEN WITH KEY WITHDRAWABLE IN OPEN POSITION FOR C.BREAKER T3

Environmental

Environmental Information	1SDC210015D0201
---------------------------	-----------------

Ordering

EAN	8015644544782
Minimum Order Quantity	1 piece
Customs Tariff Number	85389099

Dimensions

Product Net Weight	0.064 kg
--------------------	----------

Container Information

Package Level 1 Units	1 piece
Package Level 1 Gross Weight	0.064 kg
Package Level 1 EAN	8015644544782

Additional Information

Configuration Type	Loose or configurable
Product Main Type	Accessories for Tmax T
Product Name	Accessory
Product Type	ACC
Standards	IEC
Suitable For	T3
Suitable for Product Class	SACE Tmax T

Certificates and Declarations

Data Sheet, Technical Information	1SDC210015D0201
Declaration of Conformity - CE	Refer to the EU Declaration of the relative Circuit Breaker
Instructions and Manuals	1SDC210015D0201

Classifications

ETIM 7	EC002498 - Accessories for low-voltage switch technology
ETIM 8	EC002498 - Accessories/spare parts for low-voltage switch technology
Object Classification Code	Q
UNSPSC	39121100
WEEE Category	5. Small Equipment (No External Dimension More Than 50 cm)

Categories

Low Voltage Products and Systems → Circuit Breakers → Moulded Case Circuit Breakers → Accessories for Tmax T

