

M200E-DIN Clip Mounting Brackets

Instruction Sheet
R10162GB0



Schneider Electric Fire & Security Oy

Sokerilinnantie 11 C
FI-02600 Espoo, Finland
Tel: +358 10 446 511
Website: www.schneider-electric.com
Document number: R10162GB0
Published: 15.07.2019

Contents

1	M200E-DIN Clip Mounting Brackets	4
---	--	---

1 M200E-DIN Clip Mounting Brackets

The M200E-DIN Clip Mounting Brackets is used for M200 Series Input/Output Modules.

Architect/Engineer Specifications

M200 Series Input/Output Modules

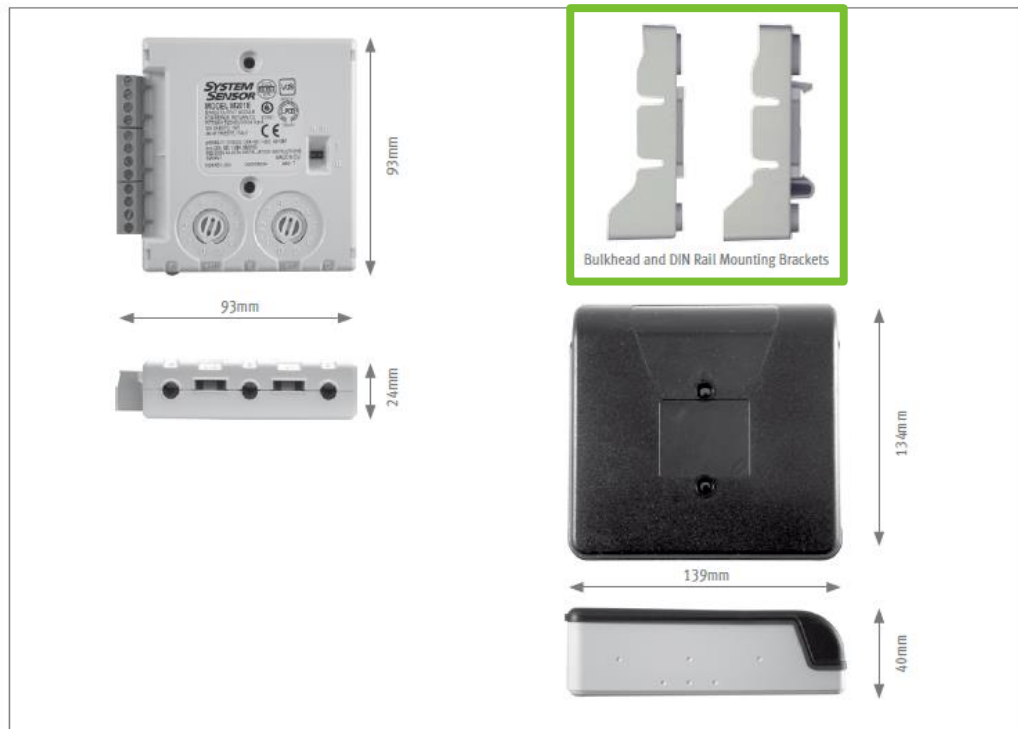

M200-DIN Clip Mounting Bracket: **FFS06717062**

List of other Accessories

FFS06717061 M200E-SMB-KO Surface Mount Box with 20mm knockouts

FFS06717063 M200-PMB Panel Mounting Clip

Modules in the range

FFS06717051E M200XE Short Circuit Isolator Module

FFS06717001 M201E Single Output Module

FFS06717010 M210E Single Input Module

FFS06717030 M210E -CZ Conventional Zone Module

FFS06717031 Conventional Zone Module EM210E-CZR

FFS06717020 M220E Dual Input Module

FFS06717021 M221E Dual Input - Single Output Module

FFS06717041 M201E-240 Mains Switching Output Module

FFS06717042 M201E-240-DIN DIN rail mount 240V Mains Switching Output Module