



Highbay EcoMax G2

- Rendabele highbay-oplossing
- Elegant, slank ontwerp
- Reflectoren, beugel en IP68 connector verkrijgbaar als accessoire



Specificaties

| Artikelcode | Artikelomschrijving | Equivalent (W) | Vermogen (W) | Lumen | Efficiëntie (lm/W) | CCT (K) | Bundelhoek | Gewicht (kg/st) |
|-----------------|--------------------------|----------------|--------------|-------|--------------------|---------|------------|-----------------|
| Statisch | | | | | | | | |
| 545001049000 | LEDHighbay-E2 240W-857-W | HID 600W | 240 | 31200 | 130 | 5700 | 90° | 3,34 |

Accessoires



545098006300
LEDHighbay-E2 Reflector-Rd602



545098006000
LEDHighbay-E2 Bracket-L249



543098021900
LEDFixture-IP68-Connector-Kit-3

Artikel- en verpakkingsinformatie

| Artikel | | | Doosverpakking | | | |
|--------------|---------------------------------|------------|-------------------------|-------------------|---------------|---------|
| Artikelcode | Artikelomschrijving | EU HS Code | Afmetingen (mm) (LxBxH) | Brutogewicht (kg) | EAN | st/doos |
| 545001049000 | LEDHighbay-E2 240W-857-W | 94051190 | 477x477x122 | 4,54 | 6941497757944 | 1 |
| 543098021900 | LEDFixture-IP68-Connector-Kit-3 | 39174000 | 265x245x205 | 0,08 | 6941497708991 | 1 |
| 545098006000 | LEDHighbay-E2 Bracket-L249 | 94059900 | 249x165x63 | 0,75 | 6941497757937 | 1 |
| 545098006300 | LEDHighbay-E2 Reflector-Rd602 | 94059900 | 602x602x225 | 1,25 | 6941497757906 | 1 |

| Technische specificaties | |
|--------------------------------|--------------------|
| Levensduur (L70) | 50.000 u |
| Levensduur (L80) | 30.000 u |
| Aan-/Uit-cycli | 100.000 |
| Kleurconsistentie (SDCM) | 4 |
| Dimbaarheid | On-Off |
| Afwerking | Grijs Pantone 417U |
| CRI | ≥ 80 |
| Beschermingsgraad (IP) | IP65 |
| Slagvastheid | IK08 |
| Beschermingsklasse | I |
| Risicogroep (EN 62471) | RG1 |
| Voorschakelapparaat inbegrepen | Ja |
| Gloeidraadtest | 850°C |
| Vermogensfactor | ≥ 0,9 |
| Piekspanning beveiliging | 4 kV |

| Elektrische aansluiting | |
|-------------------------|-----------|
| Frequentie | 50/60 Hz |
| Nom. spanning | 220-240 V |
| DC ingangsspanning | Nee |
| 230V Kabellengte | 1 m |

| Materiaal eigenschappen | |
|-------------------------|---------------|
| Materiaal behuizing | Aluminium |
| Materiaal optiek | Polycarbonaat |
| Cover materiaal | Polycarbonaat |

| Toepassingscondities | |
|----------------------|-----------|
| Bedrijfstemperatuur | -30-+50°C |
| Gebruikstemperatuur | +25°C |
| Opslagtemperatuur | -30-+50°C |





OPPLE Lighting
545001049000

| | |
|---|---|
| A | → |
| B | → |
| C | → |
| D | ← |
| E | → |
| F | → |
| G | → |

240
kWh/1000h



2019/2015

Maatschets (mm)

LEDHighbay-E2
120W & 150W

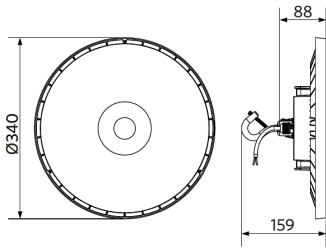

LEDHighbay-E2
200W & 240W

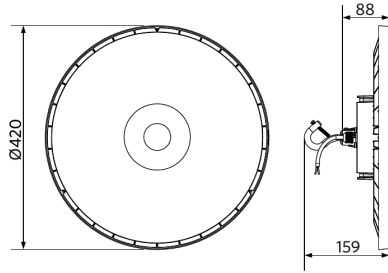

LEDHighbay-E2
Reflector-Rd407

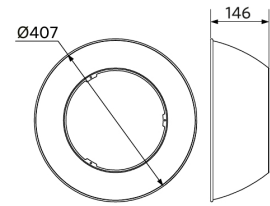

LEDHighbay-E2
Reflector-Rd507

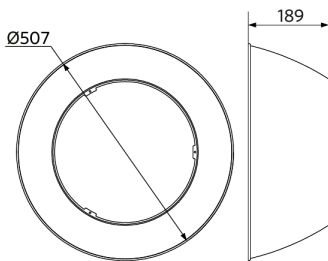

LEDHighbay-E2
Reflector-Rd602

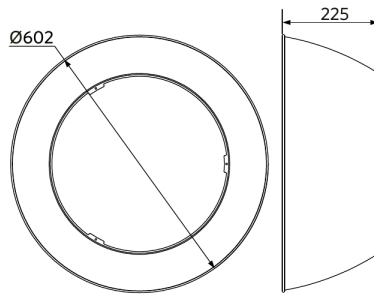

LEDHighbay-E2
Bracket

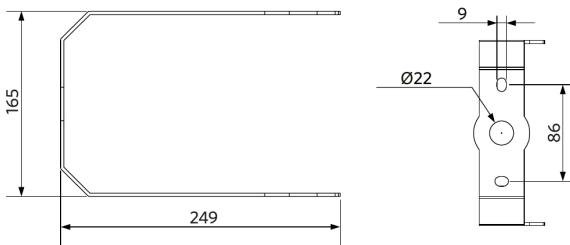

Fotometrische gegevens

