

OP-RY-CBX-TRIAC-1-250W-BLEmesh

Version date 01-05-2022
www.opple.com

Item Code		
821017001200	0.065Kg	

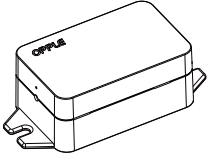
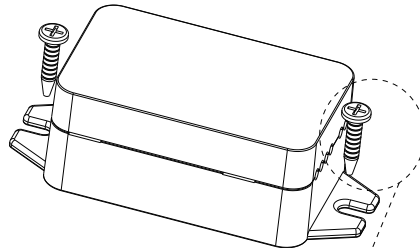
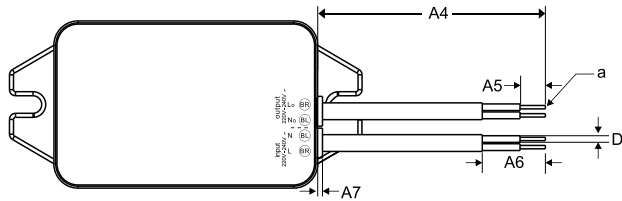
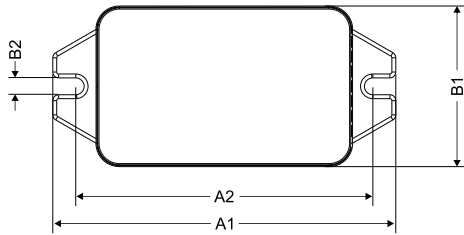
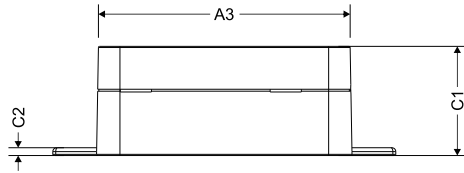

Screws should be purchased separately.

Data sheet	
Item	Dimensions
A1	88mm ± 0.1
A2	76.2mm ± 0.1
A3	64.6mm ± 0.1
A4	122.6mm ± 5
A5	8mm ± 1
A6	20mm ± 3
A7	1.5mm ± 0.1
B1	41.2mm ± 0.1
B2	4.3mm ± 0.1
C1	28mm ± 0.1
C2	2mm ± 0.1
a	0.75mm ² ± 0.1
D	2mm ± 0.1
Gross Weight: 0.094KG	

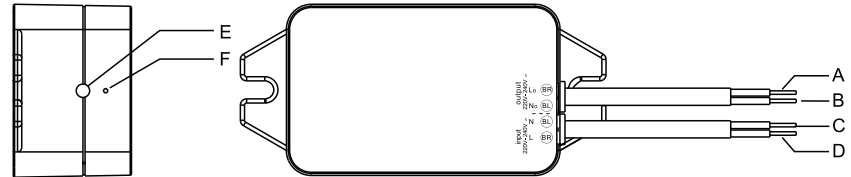
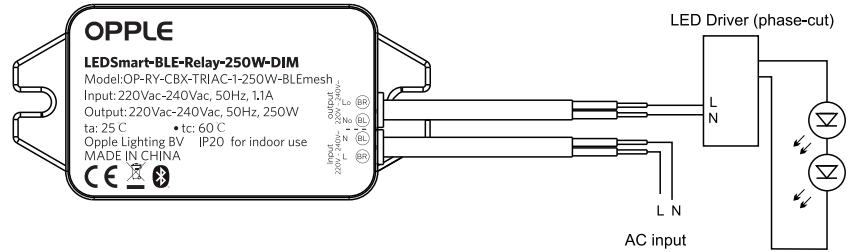

	Specification item	Definition	Remark
A	220V-240V~ Lo - Brown	Line output	
B	220V-240V~ No - Blue	Neutral output	
C	220V-240V~ N - Blue	Neutral input	
D	220V-240V~ L - Brown	Line input	
E	Push button	Reset button	
F	LED light	LED light	

Bluetooth Operating frequency: 2402-2480MHZ

Bluetooth Max. Transmission Power: <20dBm

- The Smart BLE Converter will blink if the connected devices surpass the 250W load limit
- To avoid overload, the Smart Relay will auto matically shut off if the connected devices load surpasses 275W
- Correct Disposal of this product.This marking indicates that this product should not be disposed with other household wastes throughout the EU

Data subject to change Les données sont sujettes à modifications Änderungen vorbehalten



Oppl Lighting Electronic (Zhongshan) Co., Ltd.
Building A, No.275 Dongan Bei Road, Haizhou District,
Guzhen Town, Zhongshan City, Guangdong, China.

OPPLE Lighting B.V.
Meerenakkerweg 1.11
5652 AR Eindhoven
The Netherlands
service@opple.com
www.opple.com