

# Product End-of-Life Instructions

Product Range: *Thalassa PHD*

Marketing Model/Name: (List of multiple models if applicable)

NSYPHDZT12126	NSYPLHD
NSYPHDT553	NSYFMPHD
NSYPHDT753	NSYPCVR74HD
NSYPHDZT774	NSYPCVR76HD
NSYPHDZT776	NSYPCVR54HD
NSYPHDZT1054	NSYPCVR124HD
NSYPHDZT1074	NSYPCVR126HD
NSYPHDZT1254	NSYZZ274VHD
NSYPHDZT1274	NSYZZ276VHD
NSYPHDZT1276	NSYZZ254VHD
NSYPHDZT12124	NSYZZ2124VHD
NSYPHDZT1574	NSYZZ2126VHD
NSYPHDZT1576	NSYBGN774HD
NSYPHDZT15124	NSYBGN776HD
NSYPHDZT15126	NSYBGN1054HD
NSYPHDZT2074	NSYBGN1074HD
NSYPHDT553P	NSYBGN1254HD
NSYPHDT753P	NSYBGN1274HD
NSYPHDZT774P	NSYBGN1276HD
NSYPHDZT776P	NSYBGN12124HD
NSYPHDZT1054P	NSYBGN12126HD
NSYPHDZT1074P	NSYBGN1574HD
NSYPHDZT1254P	NSYBGN1576HD
NSYPHDZT1274P	NSYBGN15124HD
NSYPHDZT1276P	NSYBGN15126HD
NSYPHDZT12124P	NSYBGN2074HD
NSYPHDZT12126P	NSYPPC54HD
NSYPHDZT1574P	NSYPPC56HD
NSYPHDZT1576P	NSYPPC74HD
NSYPHDZT15124P	NSYPPC76HD
NSYPHDZT15126P	NSYMF2PLAZ4
NSYPHDZT2074P	NSYMF2PLAZ6

## Purpose:

The product family must be disposed according to the legislation of the country. This document is intended for use by end of life recyclers or treatment facilities. It provides the basic information to assure an appropriate end of life treatment for the components and materials of the product.

## Note :

This product family *is* in the scope of EU directive 2002/96/EC, Waste Electrical and Electronic Equipment (WEEE).



**1250 x 1343 x 620 mm**  
**110 kg**

## Operations recommended for the end of life treatment

There are several steps to process the products at the end of life so as to recover components, materials or energy : Reuse → Separation for special treatment → Other dismantling → Shredding.

**The components of the products that optimize the recycling performances are listed, identified and located hereunder.**

### Components for shredding :

MARCO POLIESTER PPC 1250X620 3mm	PIEZA FIJACION FONDO PLA
COMP. PLA CANTONERA 600	PIEZA FIJ.FONDO-MONTANTE
CASQUILLO DODGE FLANGE M-6	REFUERZO LAT. ZOCALO 620
COMP.PLA TRAVESAÑO 1250 Ant Der 7035	REFUERZO CENTRAL 620 mm
COMP.PLA TRAVESAÑO 1250 Pos. Izq.R7035	REFUERZO 1250 PU/PLA MECANIZADO
LATERAL PLA 126 REFOR. ROVING	2001-S92-02 ENGAN.FALL. RAL7035
MONTANTE PLA-1250 Nu47 R7035	CONJUNTO FALLEBA
PANEL PLA-125 ANTI AF. ESPUMADA + ROVING	2001-SU 88-01 MANETA CANDADO
PANEL PLA-127 ANTI AF. ESPUMADA + ROVING	PPC ESPUMADA ALUMINIO 2mm 500X620
COMP. PLA SUP/INF 126 TROQ. NOE	PPC ESPUMADA ALUMINIO 2mm 750X620
TEJADILLO PLA-126	SOPORTE CENTRAL PLACA PASA-CABLE
SOPORTE RETEN.120u	
PLETINA RETEN.120u NOE	
BISAGRA PLA 120° ZNbl13+Org.Min.	
CONTRABIS.PLA 120° ZNbl13+Org.Min.	
PASADOR BISAGRA ACERO ZnBI-13 +org.min.	
RET. PASADOR 108 INF. RAL7035	

Disassemble and subdivide the internal units to carry out a diverse collection for the recovery of materials (steel, copper, aluminum, plastic, etc ...)

In all cases, take into account the existing regulations in the country where it is being used.

# **Visual Location Identification and location plan of particular components of representative product**

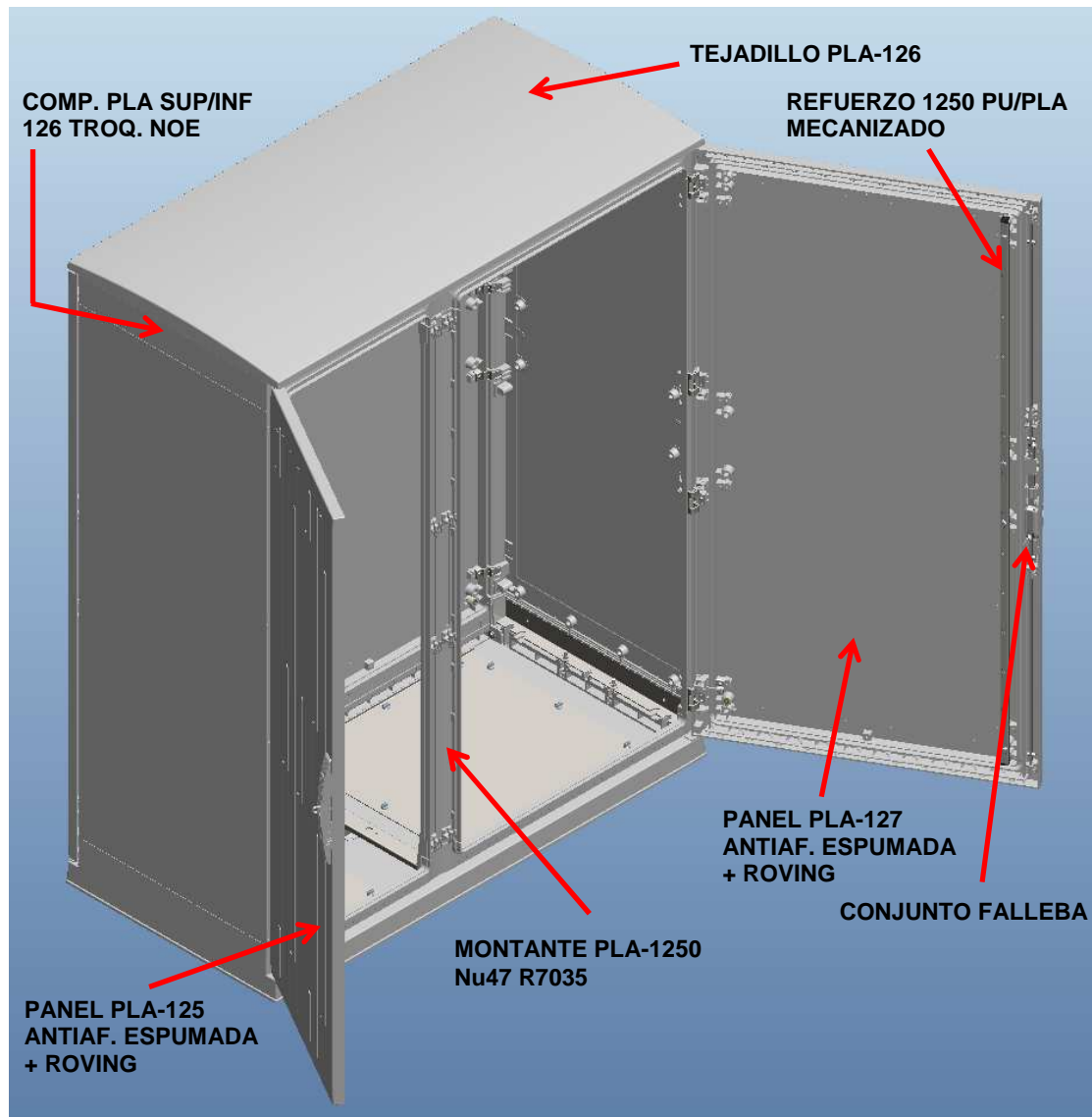

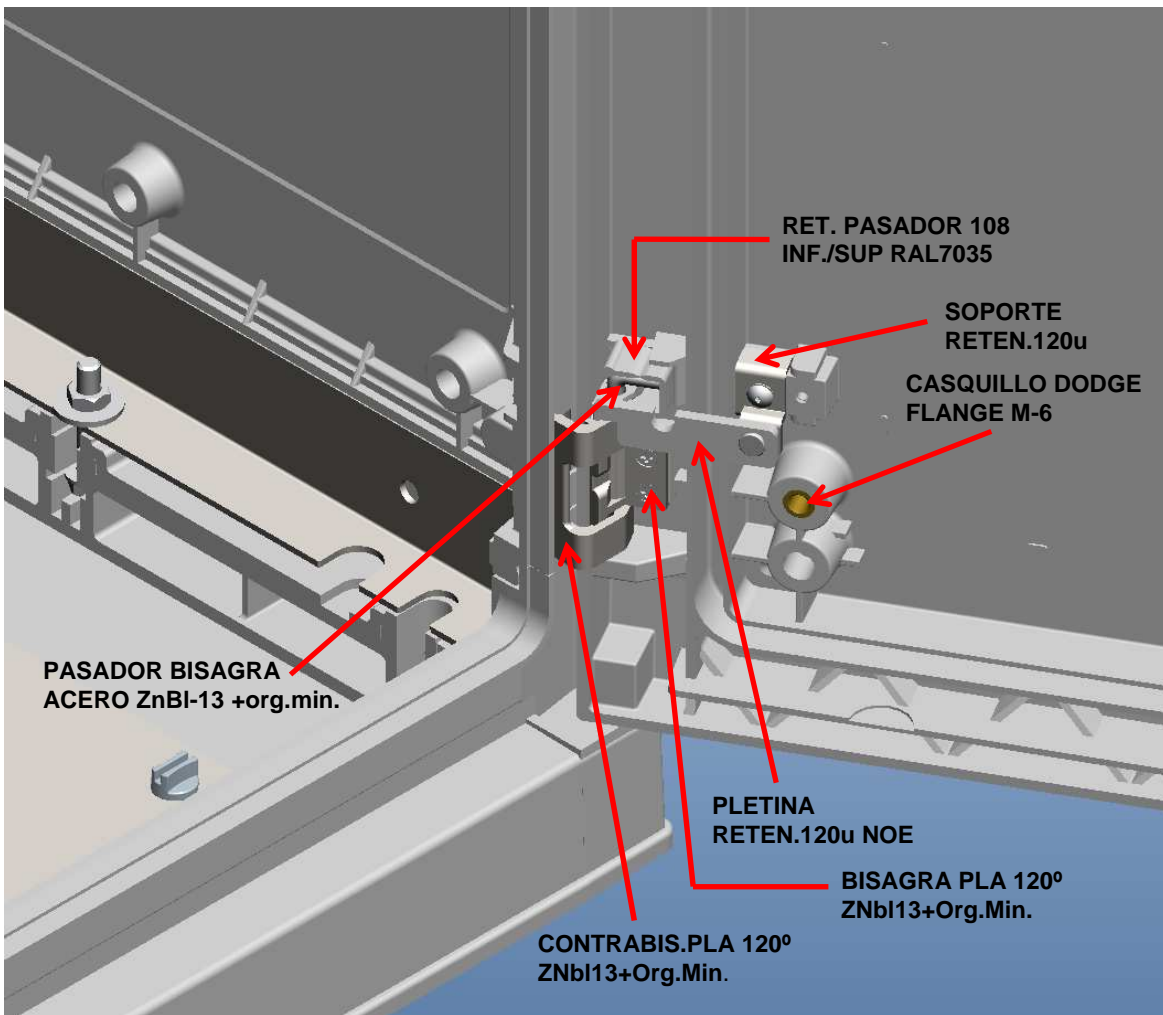
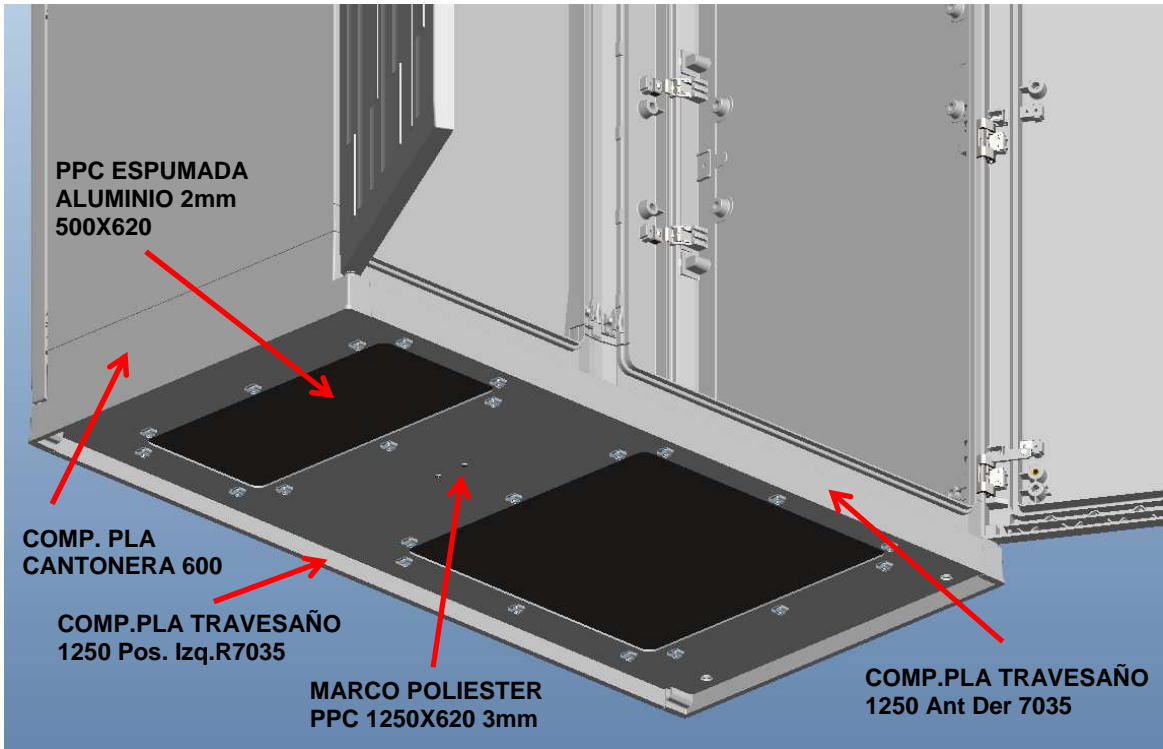

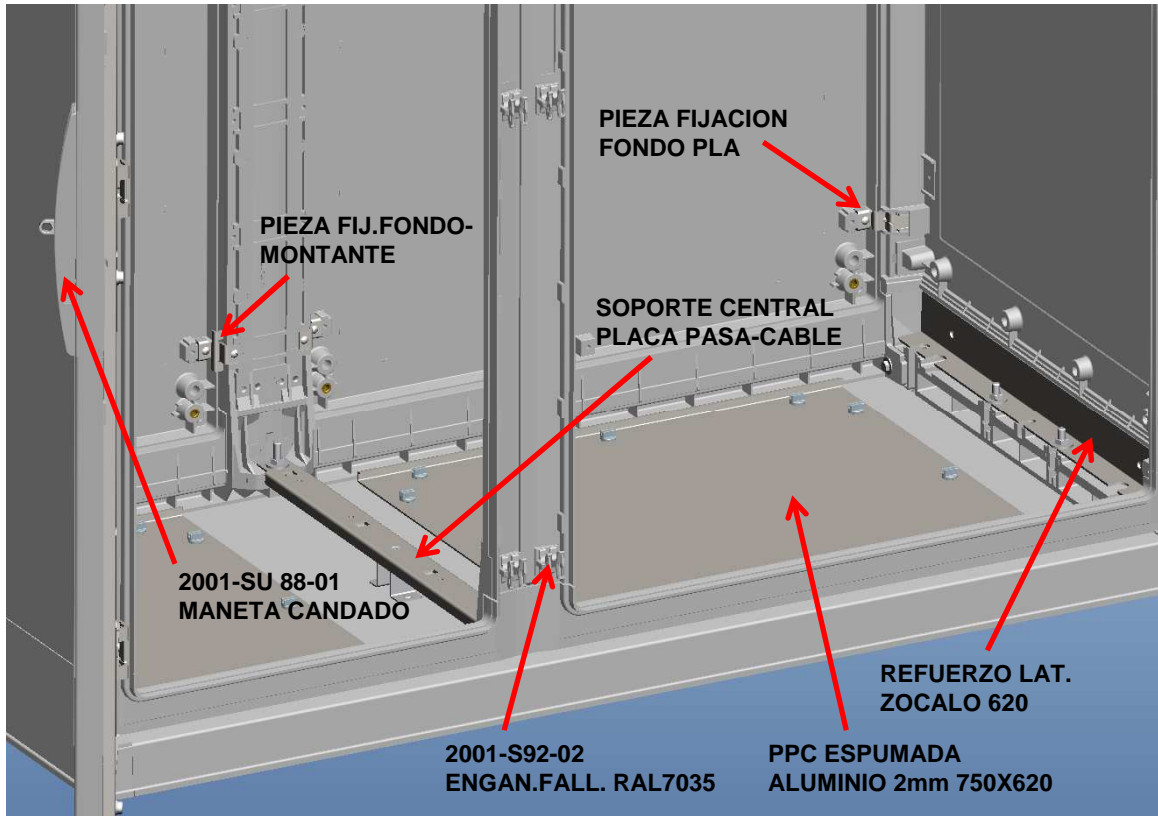

**Schneider Electric SA**  
 43-45, boulevard Franklin Roosevelt  
 F-92500 Rueil-Malmaison Cedex (France)  
 Tel.: +33 (0) 1 41 29 70 00  
 www.schneider-electric.com

The version of the Guide used to create the document: End of Life  
 Instruction Drafting Guide of Schneider Electric version V X

ENVEOLI1408007\_V1

Publication date : xx/xx/xxxx