

Product Data Sheet

GW66341N

IB Range



Industrial-type socket-outlets conforming to IEC 309 Standard, with mechanical interlock consisting of a circuit breaker enabling the plug to be connected and disconnected only in the open position, and the switch to close only with the plug inserted. Wide range including models with rotary switch and fuseholder base, AUTOMATIKA with 6kA C characteristic miniature circuit breaker, and version with safety transformer. High application versatility thanks to the possibility of assembly in back-mounting and flush-mounting boxes, and boards of the 68 Q-DIN and Q-MC ranges.

| | | | |
|---------------------------------|------------------------|-------------------------------------|-------------|
| Type of fuse | Ø 10.3x38 mm | Type | Vertical |
| Fuse breaking capacity | > 50 kA | Thermo-pressure with ball | 125 °C |
| Rated insulation voltage (Ui) | 500 V | IP degree | IP67 |
| No. of poles | 3P+E | Mechanical resistance | IK08 |
| Frequency | 50/60 Hz | Operating temperature | -25 +40 °C |
| Protection | Fuse-holder base (CBF) | With back-mounting box | No |
| Electrocod | 2222 | Glow wire test | 850 °C |
| Colour | Red | Breaking capacity (Icc) | 10 kA |
| Weight | Max. 0.9 Kg | IB socket outlet rated current (In) | 27 A |
| Rated impulse withstand voltage | 4 kV | Rated current (A) | 32 |
| Reference h | 6 | Rated voltage | 380 - 415 V |

BEHAVIOUR WITH CHEMICAL AND ATMOSPHERIC AGENTS

| Saline solution | Acids | | Bases | | Solvents | | | | Mineral oil | UV rays |
|-----------------|---------------|--------------------|--------------------|--------------------|--------------------|---------------|---------------|--------------------|--------------------|-----------|
| | Concentrated | Diluted | Concentrated | Diluted | Hexane | Benzol | Acetone | Alcohol | | |
| Resistant | Not resistant | Limited resistance | Limited resistance | Limited resistance | Limited resistance | Not resistant | Not resistant | Limited resistance | Limited resistance | Resistant |

DIMENSIONAL

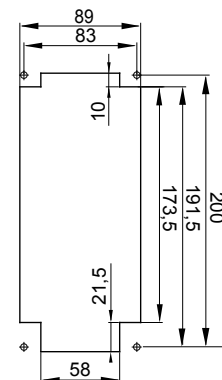
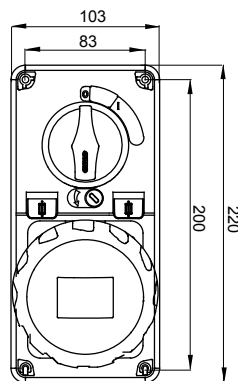
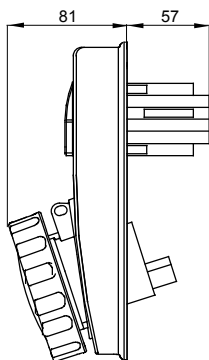

TECHNICAL SYMBOLOGY



IP
IP67

IK
IK08



GWT
850 °C

STANDARDS/APPROVALS

