

# Product Data Sheet

## GW94670

90 RCD Range



|   |                                  |
|---|----------------------------------|
| Description                               | RESIDUAL CURRENT CIRCUIT BREAKER |
| Code                                      | SD                               |
| No. of poles                              | 4P                               |
| No. modules                               | 3                                |
| Rated current                             | 40 A                             |
| Rated residual operating current          | 500 mA                           |
| Type                                      | AC                               |
| Rated voltage (EN/IEC 61008-1, 61008-2-1) | 400/415 V                        |

|                           |                                   |                                 |                                  |
|---------------------------|-----------------------------------|---------------------------------|----------------------------------|
| Standard                  | IEC/EN 61008-1, IEC/EN 61008-2-1  | Rated frequency (Hz)            | 50Hz                             |
| Insulation voltage        | 500 V                             | Rated impulse withstand voltage | 4 kV                             |
| Overvoltage category      | III                               | Level of immunity (8/20 μs)     | 250 A                            |
| Section rigid cable       | <=1x35 - <=2x16 - <=1x16+2x10 mm² | Section flexible cable          | <=1x25 - <=1x16+1x10 - <=3x6 mm² |
| Rated tightening torque   | 2 Nm                              | Double connection               | YES (up stream and down stram)   |
| Operating temperature     | -25 +40 °C                        | Stocking temperature            | -40 +70 °C                       |
| Electrical endurance      | ≥ 5000                            | Mechanical endurance            | ≥ 10.000                         |
| Auxiliaries compatibility | Yes                               | ReStart compatibility           | No                               |
| Assembly position         | Any                               |                                 |                                  |

### DIMENSIONAL

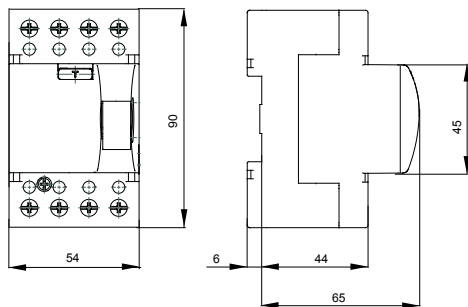

### WIRING DIAGRAM

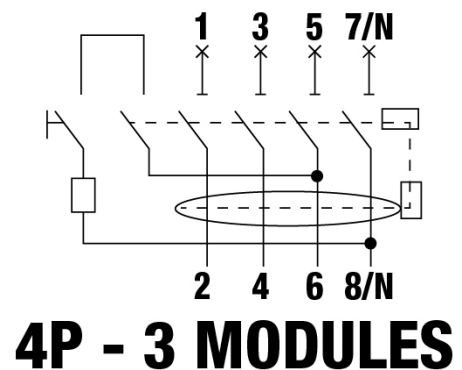

### STANDARDS/APPROVALS

