

item number	A	B	C	weight kg/pc	max. load kg
DT 100_F	120	120	60	0,30	250
DT 150_F	170	120	60	0,36	250
DT 200_F	220	120	60	0,43	250
DT 250_F	270	120	60	0,53	250
DT 300_F	320	135	60	0,73	325
DT 400_F	420	135	60	0,88	325
DT 500_F	520	155	90	1,30	350
DT 600_F	620	155	90	1,60	350
DT 800_F	820	155	90	1,90	250
DT 1000_F	1020	155	90	2,40	180



product description: The bracket is used as an element to create a supporting structure for a cable tray.

It is designated for installation on the wall or ceiling profile SPL or SPS.

For assembly to the ceiling profile there are used the sliding nuts PM 41 M 10 (PMP 41 M 10) together with the bolts S 10X20 (S 10X25 or S 10X30).

NSM 6X10 bolts are used to attach the cable tray to the bracket. An SUP fastening clamp is suitable for attaching to a cable ladder. To protect the cables, the bolt head is inside the cable tray.

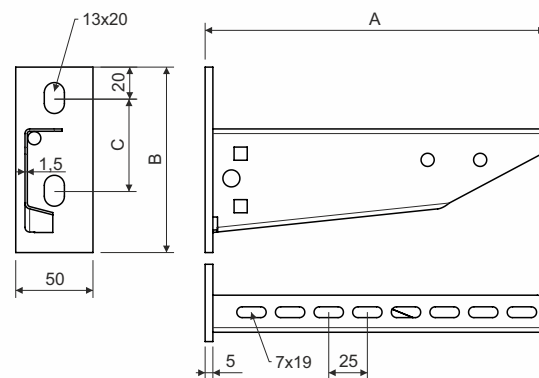

surface finish: F - Hot Dip Galvanized according to ČSN EN ISO 1461, zinc-layer 55 µm (min. 45 µm)

sales amount: á 1 pc

storage: EN 60721-3-1

