

Product End of Life Instructions

**Altivar Soft Starter ATS480 170A 208 to 690V AC control supply
110 to 230V AC**

Altivar Soft Starter



Introduction and Scope

Legal Information	This product family is in the scope of European Union directive 2012/19/EU on Waste Electrical and Electronic Equipment (WEEE). This product may only be dismantled/disassembled and disposed of by appropriately trained persons and in compliance with all applicable regulations.	
Purpose	This document is intended for use by professional end of life recyclers or waste treatment facilities. It provides the basic information for proper end-of-life treatment of product components and materials.	
In case of special transportation: transportation method	No special transportation.	
Recyclability potential	71%	Based on "ECO'DEEE recyclability and recoverability calculation method" (version V1, 20 Sep. 2008 presented to the French Agency for Environment and Energy Management: ADEME).

Safety Information

The information provided in this document assumes that the product is completely de-energized and uninstalled (refer to the instructions provided in the appropriate product manuals).

Dismantling/disassembling the product may entail hazards caused by, for example, sharp edges, chemical aggression or ejected parts.

⚠ WARNING

HAZARD DUE TO INSUFFICIENT PROTECTION

- Implement all safety measures required by the applicable regulations and by the processes used to dismantle/disassemble and dispose of the product.
- Use all necessary personal protective equipment such as gloves and goggles.

Failure to follow these instructions can result in death or serious injury.

End of Life Instructions

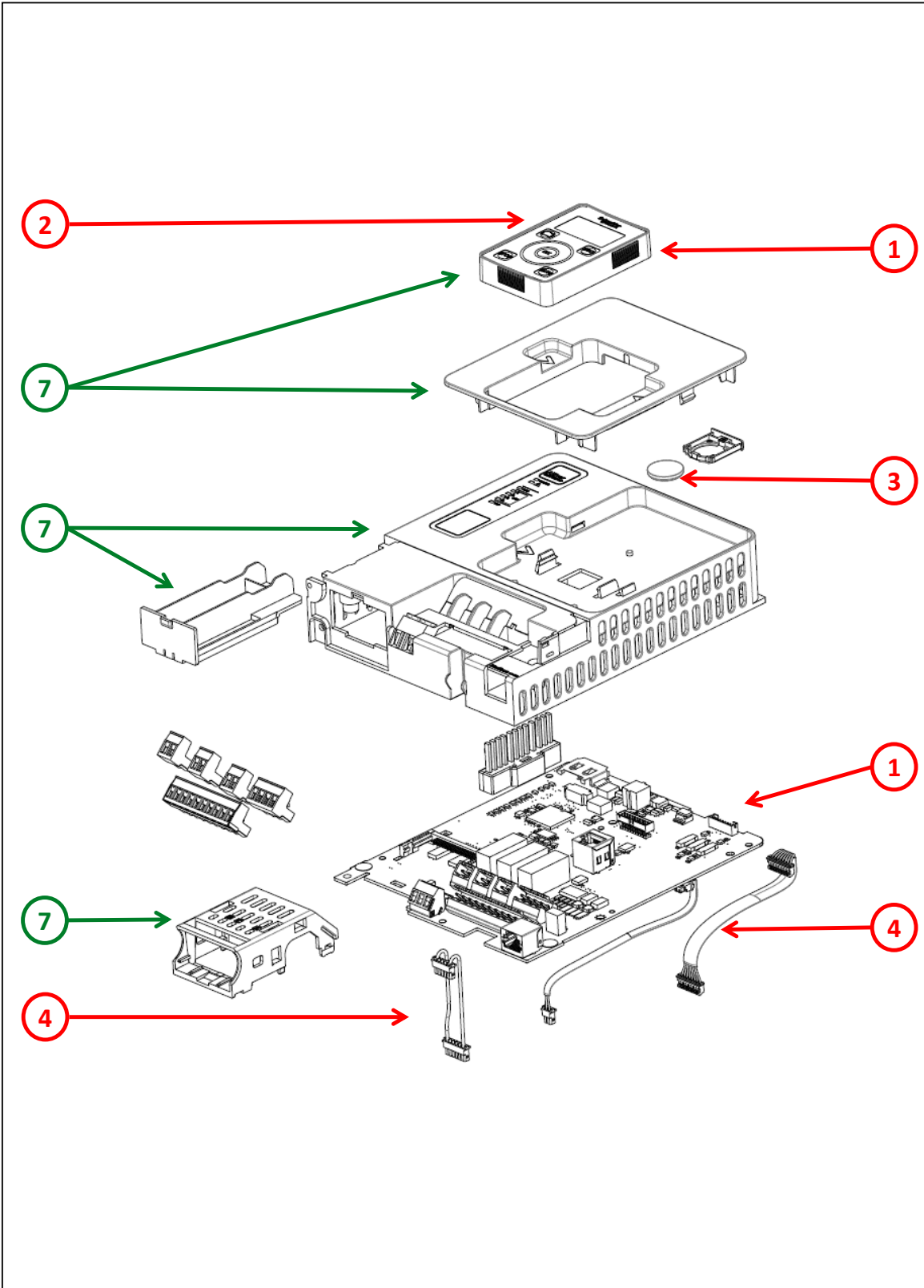

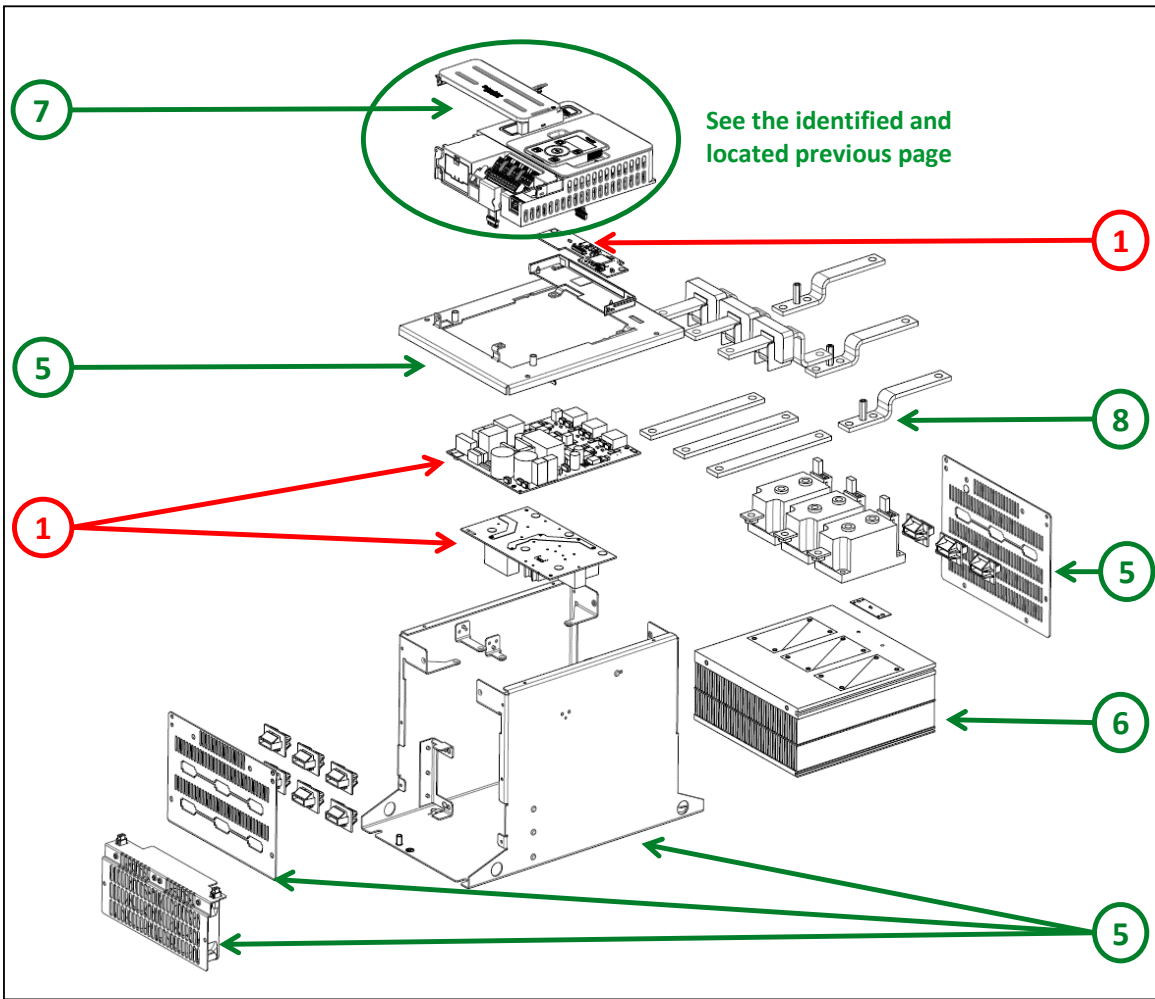

Recommendation	Number on drawing	Component / Material	Weight (in g)	Comment
To be depolluted	1	Electronic Board (Power and Communication) > 10cm ²	705	
To be depolluted	2	LCD and all those back-lighted with gas discharge lamps	6,75	
To be depolluted	3	Other battery	2,9	Lithium content: 0,07 g
To be depolluted	4	Cable (high current)	48	
To be dismantled	5	Steel	3524	Main frame, Support, Front cover and Hood
To be dismantled	6	Aluminium	4005	Heatsink
To be dismantled	7	PC, ABS-PC, PA, PA6, HDPE, SAN with or without additive, PP+EPDM and PP	291	Support, Cover, Housing, Gasket and Control door
To be dismantled	8	Copper	899	Bar
Other			3118,35	



Product description

Manufacturer identification	Schneider Electric Industries SAS
Brand name	Schneider Electric
Representative product	Altivar Soft Starter ATS480 170A 208 to 690V AC control supply 110 to 230V AC - ATS480C17Y
Description of the product	The main function of the Altivar Soft Starter product range is primarily to intend for the soft starting and breaking of the rotational speed of an asynchronous electric motor for heavy duty industry and pumps.
Description of the range	This range consists of products ATS480 with ratings from 140A to 170A for operation on 208 to 690V AC control supply 110 to 230V AC, 3-phase supplies IP20.
Additional similar product references	ATS480C17Y ATS480C14Y
Total representative product mass	12,6 kg
Representative product dimensions	200 mm x 340 mm x 280 mm
Accessories	No accessories needed.
Date of information release	11/2021

Schneider Electric Industries SAS

Country Customer Care Center <http://www.se.com/contact>

35, rue Joseph Monier

CS 30323

FR- 92500 Rueil Malmaison Cedex

RCS Nanterre 954 503 439

Capital social 896 313 776 €

www.se.com

Published by Schneider Electric

ENVEOLI2009022_V1

© 2021 - Schneider Electric – All rights reserved

11/2021